

RANGE	CODE	MODEL	FUNCTION
Refrigerated Counters	MACRO0000080	TRE2PBTSP	Refrigerated Counters MO

ITEM

Refrigerated counter MO 2 doors -10-20°C without top



RANGE	CODE	MODEL	FUNCTION
Refrigerated Counters	MACRO0000080	TRE2PBTSP	Refrigerated Counters MO

ITEM

Refrigerated counter MO 2 doors -10-20°C without top



TECHNICAL SPECIFICATIONS

RANGE:	-20/-10°C
WIDTH (mm):	1343
DEPTH (mm):	680
HEIGHT (mm):	810
WEIGHT (Kg):	151
VOLUME (m ³):	0.78
EL. POWER (kW):	0.5
VOLTAGE:	VAC230
FREQUENCY (Hz):	50Hz
INTERNAL DIM. (mm):	791x530x540(h) mm
EXTERNAL MATERIAL:	304
INTERNAL MATERIAL:	304
GROSS CAPACITY (L):	226
OPERATING MODE:	Ventilated
DOORS:	2 Doors
STANDARD EQUIPMENT:	1 Plastic-coated grid GNI/I for each door.
DEFROST TYPE:	Hot gas
REFRIGERANT POWER:	520
ENERGY CLASS: D	GAS TYPE: R290 / 3
REFRIGERANT QUANTITY (g):	120
NOISE LEVEL:	53
ENERGY PER YEAR:	2587
CLIMATE CLASS:	5 + 40°C 40%

DESCRIPTION

Single-shell structure H=670mm. in stainless steel AISI 304. Without top. External scotch-brite satin finish. 50mm insulation thickness for the casing and 50mm for the doors with high density foam (40 kg/mc). External back plate in galvanized steel, as option in stainless steel AISI 304 scotch-brite. Feet in stainless steel adjustable in height H 140/230mm. Cell with rounded corners for a more effective internal cleaning. Self-closing doors with safety stop at 95°. Easily removable door and drawers magnetic gaskets. Monobloc refrigerating unit. Automatic defrost and automatic evaporation of condensation water. Ergonomic handles. Standard power supply 230V/50Hz. Equipped with 2 GN I/I plastic-coated steel grids. Refrigerant gas R290. Energy Efficiency class D (2587 kWh/year)



RANGE	CODE	MODEL	FUNCTION
Refrigerated Counters	MACRO0000080	TRE2PBTSP	Refrigerated Counters MO

ITEM

Refrigerated counter MO 2 doors -10-20°C without top

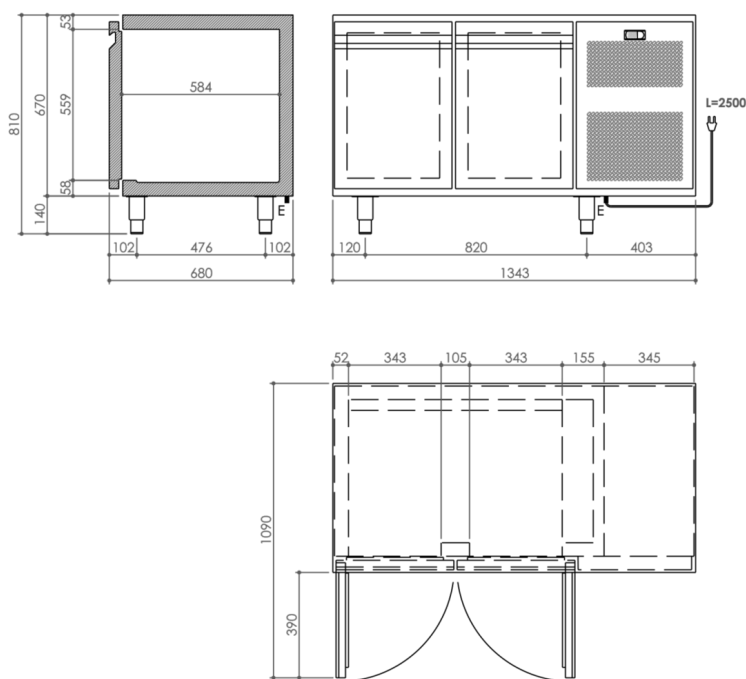

INSTALLATION SPECIFICATIONS

(E) Electrical Connection:

VAC230 50Hz

Type of electrical plug:

with Schuko plug and cable

