

RANGE

**Rack conveyor dishwashers**

CODE

**CR1300870**

MODEL

**MRXE184EASD**

ITEM

**Rack conveyor Dishwasher RX Evo Electric version - Rh with pre-rinse module and automatic shower**



RANGE

**Rack conveyor dishwashers**

CODE

**CR1300870**

MODEL

**MRXE184EASD**

ITEM

**Rack conveyor Dishwasher RX Evo Electric version - Rh with pre-rinse module and automatic shower**



**TECHNICAL SPECIFICATIONS**

WIDTH (mm):	<b>2950</b>
DEPTH (mm):	<b>805</b>
HEIGHT (mm):	<b>1830</b>
WEIGHT (Kg):	<b>365</b>
VOLUME (m <sup>3</sup> ):	<b>4.32</b>
GAS POWER (kW):	<b>0</b>
EL. POWER (kW):	<b>23.82</b>
VOLTAGE (V):	<b>400V 3N</b>
FREQUENCY (Hz):	<b>50 Hz</b>
BASKET SIZE (mm):	<b>500x500</b>
MAX PLATE DIAMETER (mm):	<b>450</b>
GN/EN:	<b>GN I/I</b>

**SEC./CYCLE                      BASKETS/HOUR - 10°C**





RANGE

Rack conveyor dishwashers

CODE

CR1300870

MODEL

MRXE184EASD

ITEM

Rack conveyor Dishwasher RX Evo Electric version - Rh with pre-rinse module and automatic shower

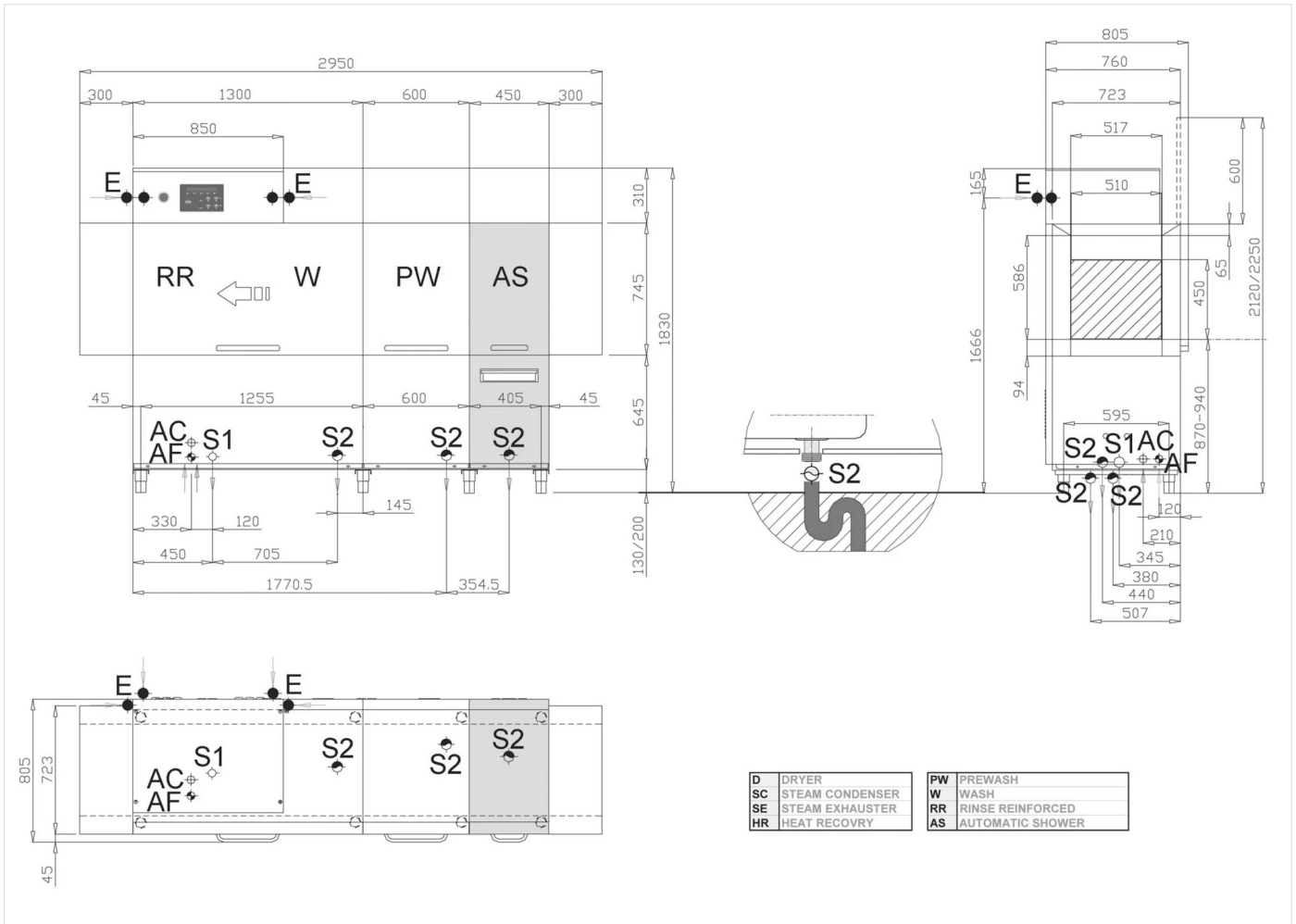

## INSTALLATION SPECIFICATIONS

(E) Electrical Connection:	400V 3N 50 Hz
(AF) Cold Water Inlet:	Ø3/4-H=150mm
(AC) Hot Water Inlet:	Ø3/4-H=150mm-60°C(2/4bar)
(S) Output Drain:	Ø28mm-H=200mm

