

RANGE

Washers

CODE

CR1301130

MODEL

MLP1800

ITEM

LPI-series electric warewasher**DESCRIPTION**

AISI 304 stainless steel electric pot and utensil washer. 5 Wash cycles. Load capacity 805 mm. Double-walled door. Double tank filter + pump filter. Easy access for maintenance. Moulded tank. Pressure booster pump as standard. Anti-drip roof. Automatic self-cleaning cycle. Basket 550x665. Stainless steel wash and rinse arms. Baskets/hour 30/15/10/7.5/6. Washing cycles 120/240/360/480/600. Washing pump kW 2,18. Boiler heating element kW 6. Tank heating element kW 2.7. Total absorption kW 8.18. Tank capacity lt. 35. Boiler capacity lt. 10. Water consumption lt. 4.7. Basket size 550x665 cm. Useful height mm. 805. Maximum tray height 805. Standard accessories: 1 x Stainless steel basket, 1 x Stainless steel grid, 1 x Stainless steel tray holder, 1 x Stainless steel spatula holder.



RANGE

Washers

CODE

CR1301130

MODEL

MLP1800

ITEM

LPI-series electric warewasher

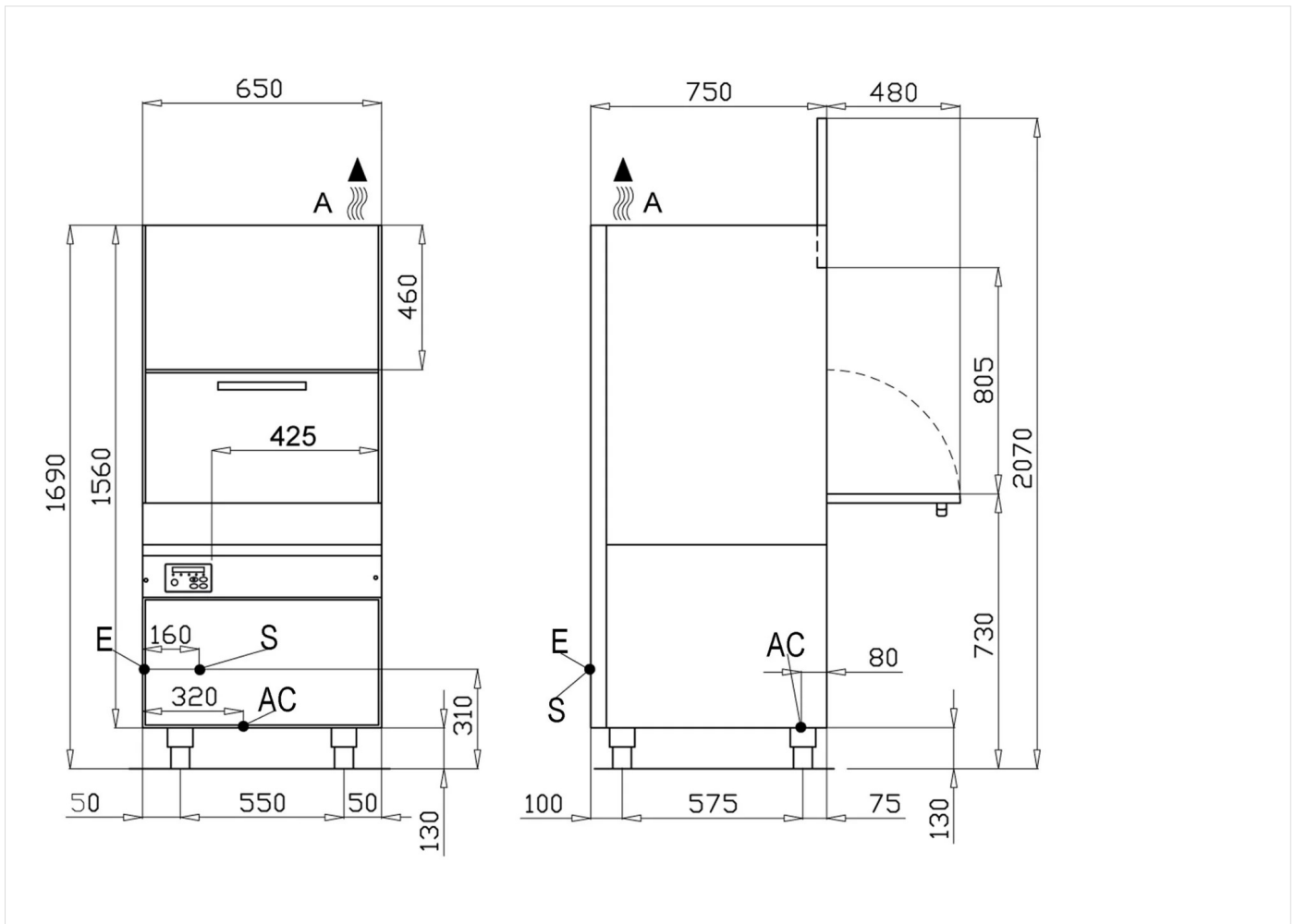

INSTALLATION SPECIFICATIONS

(E) Electrical Connection:	400V 3N 50 Hz
(AC) Hot Water Inlet:	Ø3/4-H=130mm-60°C(2/4bar)
(S) Output Drain:	Ø24mm-H=310mm.

