

RANGE

Washers

CODE

CRI30I150

MODEL

MLPIS8TRP

ITEM

LPI-series electric warewasher with heat recovery unit



RANGE

Warewashers

CODE

CRI30I150

MODEL

MLPIS8TRP

ITEM

LPI-series electric warewasher with heat recovery unit



TECHNICAL SPECIFICATIONS

WIDTH (mm):	690
DEPTH (mm):	800
HEIGHT (mm):	2165
OPEN HEIGHT (mm):	2270
WEIGHT (Kg):	165
VOLUME (m ³):	1.2
GAS POWER (kW):	0
EL. POWER (kW):	8.18
VOLTAGE (V):	400V 3N
FREQUENCY (Hz):	50 Hz
WATER PRESSURE:	200-400 kPa
BASKET SIZE (mm):	550X665
INTERNAL OVEN DIM. (mm):	805
BOILER CAPACITY (L):	15
BOILER RESISTANCE (kW):	6
TANK CAPACITY (L):	50
TANK RESISTANCE (kW):	3
WASHING PUMP POWER (W):	2000
DRAIN PUMP POWER (W):	190
N° CYCLES:	4
MAX PLATE DIAMETER (mm):	805

SEC./CYCLE	BASKETS/HOUR - 10°C
120 "	15
240 "	15
360 "	10
480 "	7.5



RANGE

Warewashers

CODE

CRI30I150

MODEL

MLPIS8TRP

ITEM

LPI-series electric warewasher with heat recovery unit**DESCRIPTION**

AlSi 304 stainless steel electric pot and utensil washer. Electronic, with energy saving function. Double-walled. Rinse pump as standard. Self-cleaning vertical pump. Fully moulded staged tank. Independent stainless steel wash/rinse arms. Double tank filter with drain, removable waste collector and pump filter. Thermostop to ensure rinsing temperature in accordance with HACCP requirements. Multichromatic Start key. Automatic self-cleaning cycle. Double skinned door that can be used as a countertop. Steam condenser. Heat recovery system. The TR system operates with a heat exchanger: the hot, moist steam produced by the machine is drawn in and used to preheat the cold incoming water to around 50°C, reducing the energy and time needed to reach the 85°C final rinse, thus reducing costs. Backlit multichrome start button, with multichrome and flashing functions, indicates the status of the washer in real time. Each colour indicates a precise work step: White: programming Red: loading and heating Flashing red: alarm Green: machine ready Green and Flashing light blue: cycle end Light blue: cycle running Flashing light blue: tank drain, boiler total drain, self-cleaning and regeneration Baskets/hour 12/13/8/6.5/5.5. Washing cycles 180/300/420/540/660. Washing pump kW 2.18. Boiler heating element kW 6. Tank heating element kW 3. Total absorption kW 8.18. Tank capacity lt. 50. Boiler capacity lt. 15. Water consumption lt. 4.2. Basket size 550x665 cm. Useful height mm. 805. Maximum tray height 805. Standard accessories: 1 x Stainless steel basket, 1 x Stainless steel grid, 1 x Stainless steel tray holder, 1 x Stainless steel spatula holder.



RANGE

CODE

MODEL

Wearwashers

CRI30I150

MLPIS8TRP

ITEM

LPI-series electric warewasher with heat recovery unit

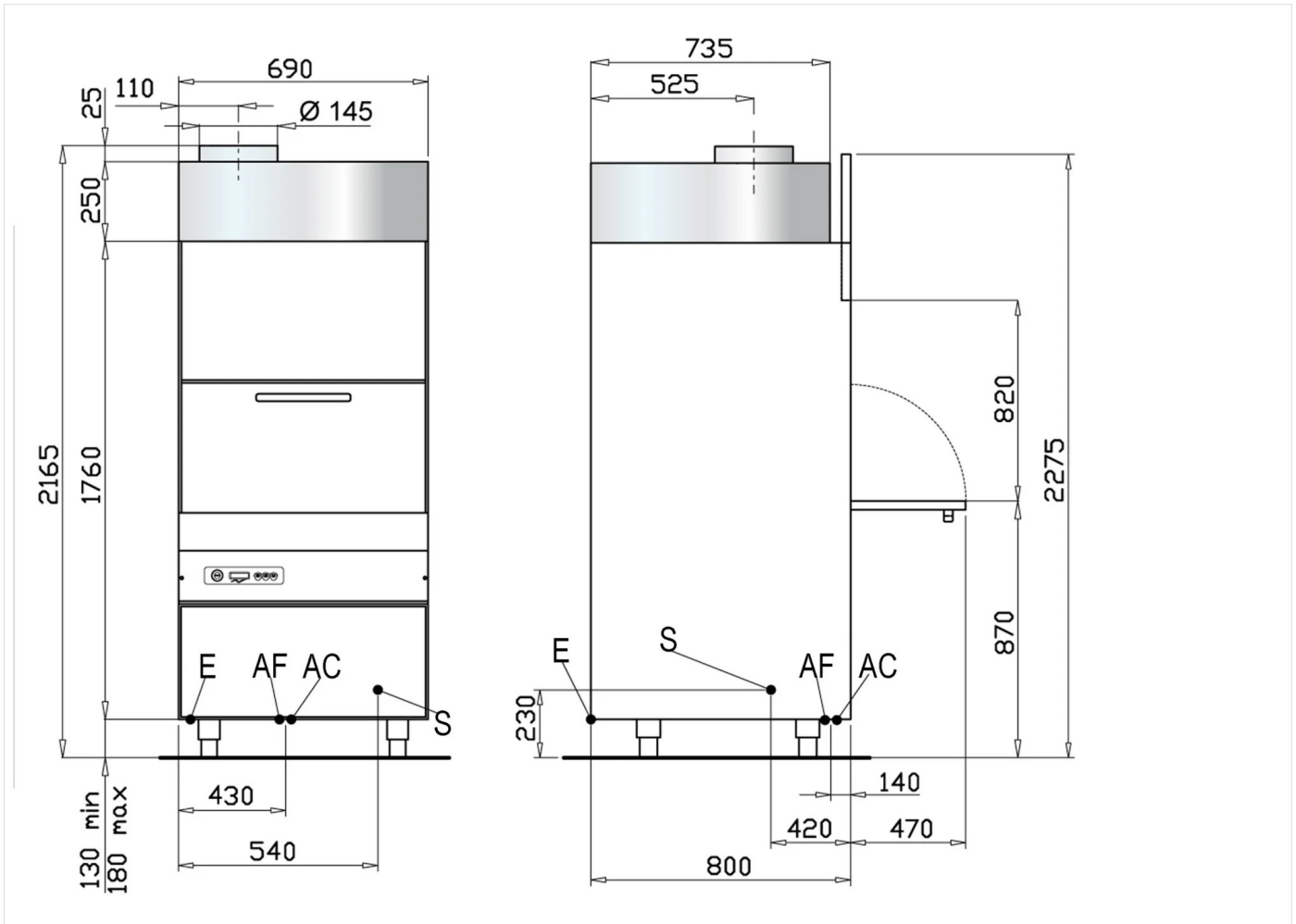

INSTALLATION SPECIFICATIONS

(E) Electrical Connection:	400V 3N 50 Hz
(AF) Cold Water Inlet:	Ø3/4-H=150mm-60°C(2/4bar)
(AC) Hot Water Inlet:	Ø3/4-H=130mm-60°C(2/4bar)
(S) Output Drain:	Ø24mm-H=310mm.

